



The Waterford 245

The Waterford is a great four bedroom home. With a real sense of spaciousness and style, it's bound to please!

A balanced aspect gives the home beautiful street appeal, making it a very popular design. The home features a split living area, and is compliant with all the developments in Darwin. It also features cross flow ventilation in the living areas, ensuring a breezy comfortable environment for living.

Modern, attractive, and energy efficient, what more could you want from your new home?

At a glance

Living area	140m ²
Verandahs	22m ²
Garage	38m ²
Width	10.9m
Length	20.7m

Suited to blocks with 15m or greater frontage.

We build your Waterford home from

\$417,750

Suburbs this home has been built in:
Lyons, Muirhead, Durack

Audited Energy Rating



With Killarney Homes, you'll get:

- Maximum energy efficiency, with 6-Star minimum energy ratings
- 600mm tiles throughout the home, standard
- Stone benchtops in kitchen and bathroom
- Stainless steel security screens and grey glass to windows, standard
- Good provision of windows for natural light and airflow
- Full Colourbond 25 degree roof, to keep your home cool all year round
- Fujitsu Inverter air-conditioning throughout
- Solahart solar hot water system
- Solar Power ready for install
- Double carport (or garage, depending on your final design)
- 2700mm high ceilings
- Exposed aggregate outdoors throughout
- Energy saving downlights throughout
- Outstanding quality materials and finishes
- Award-winning kitchen and bathroom designers to create your personal design
- Your choice of ovens and cooktops from a massive range
- Modern bathroom fittings
- Your own personal Design Consultant to create your home with your choice of colours, paint, laminates, tiles, and much more!
- 12-month KillarneyCare post-construction package, standard

killarneyhomes.com.au



The Waterford 245

Ground floor plan

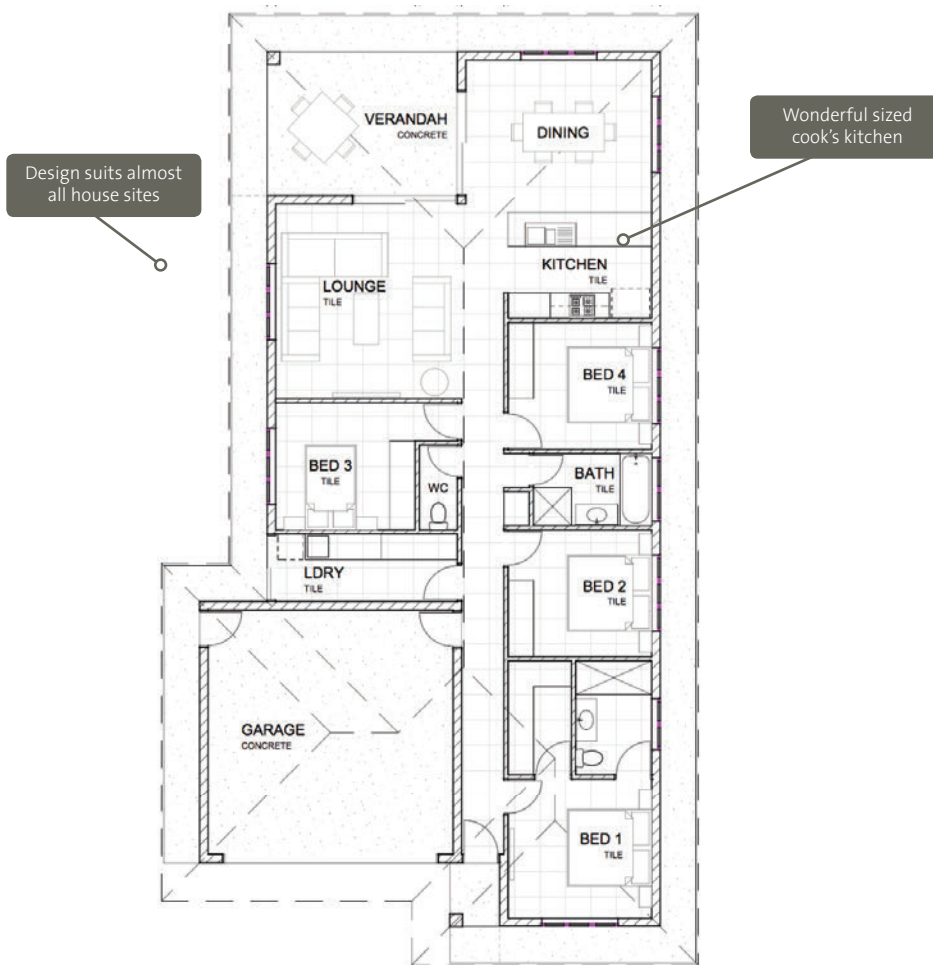

About Killarney Homes

At Killarney Homes, we're all about building your future with the best in beautiful, energy efficient homes for the tropics.

Our success as one of the Territory's highest-profile and most-respected building companies lies in our clear communication, efficient processes, and high quality, energy efficient housing that meets and exceeds the needs of our customers. Recently, this success culminated in us winning the 2014 Telstra Business Awards in the

Northern Territory Medium Business category. We're also proud to be on the board of the Northern Territory Master Builders Association and have won 80+ awards, including numerous HIA and GreenSmart accolades, cementing our reputation as the leader in sustainable Top End construction.

If you're ready to build your future with a beautiful, energy efficient home designed especially for the tropics, you're in the right place.

Contact us today



sales@killarneyhomes.com.au
PO Box 39947
Winnellie NT 0821



killarneyhomes.com.au (08) 8931 2122