



The Tipperary 230

The Tipperary is our most popular home for first home owners, offering terrific value for money.

Good size rooms, and separate ensuite and bathroom areas make this a very liveable first home.

The verandah and living area combine to offer an integrated outdoor space, and this design makes the most of just about all block shapes. Choose from a carport or a garage, depending on your needs. The design works great with both!

The Tipperary is available for viewing as a display home by appointment, 7 days a week. Come and experience the Killarney difference for yourself.

At a glance

Living area	110m ²
Verandahs	24m ²
Garage	38m ²
Width	11.0m
Length	20.0m

Suited to blocks with 15m or greater frontage.

We build your Tipperary home from

\$370,920

Suburbs this home has been built in:
Lyons, Muirhead, Durack, Zuccoli

Audited Energy Rating



With Killarney Homes, you'll get:

- Maximum energy efficiency, with 6-Star minimum energy ratings
- 600mm tiles throughout the home, standard
- Stone benchtops in kitchen and bathroom
- Stainless steel security screens and grey glass to windows, standard
- Good provision of windows for natural light and airflow
- Full Colourbond 25 degree roof, to keep your home cool all year round
- Fujitsu Inverter air-conditioning throughout
- Solahart solar hot water system
- Solar Power ready for install
- Double carport (or garage, depending on your final design)
- 2700mm high ceilings
- Exposed aggregate outdoors throughout
- Energy saving downlights throughout
- Outstanding quality materials and finishes
- Award-winning kitchen and bathroom designers to create your personal design
- Your choice of ovens and cooktops from a massive range
- Modern bathroom fittings
- Your own personal Design Consultant to create your home with your choice of colours, paint, laminates, tiles, and much more!
- 12-month KillarneyCare post-construction package, standard

killarneyhomes.com.au



The Tipperary 230

Ground floor plan

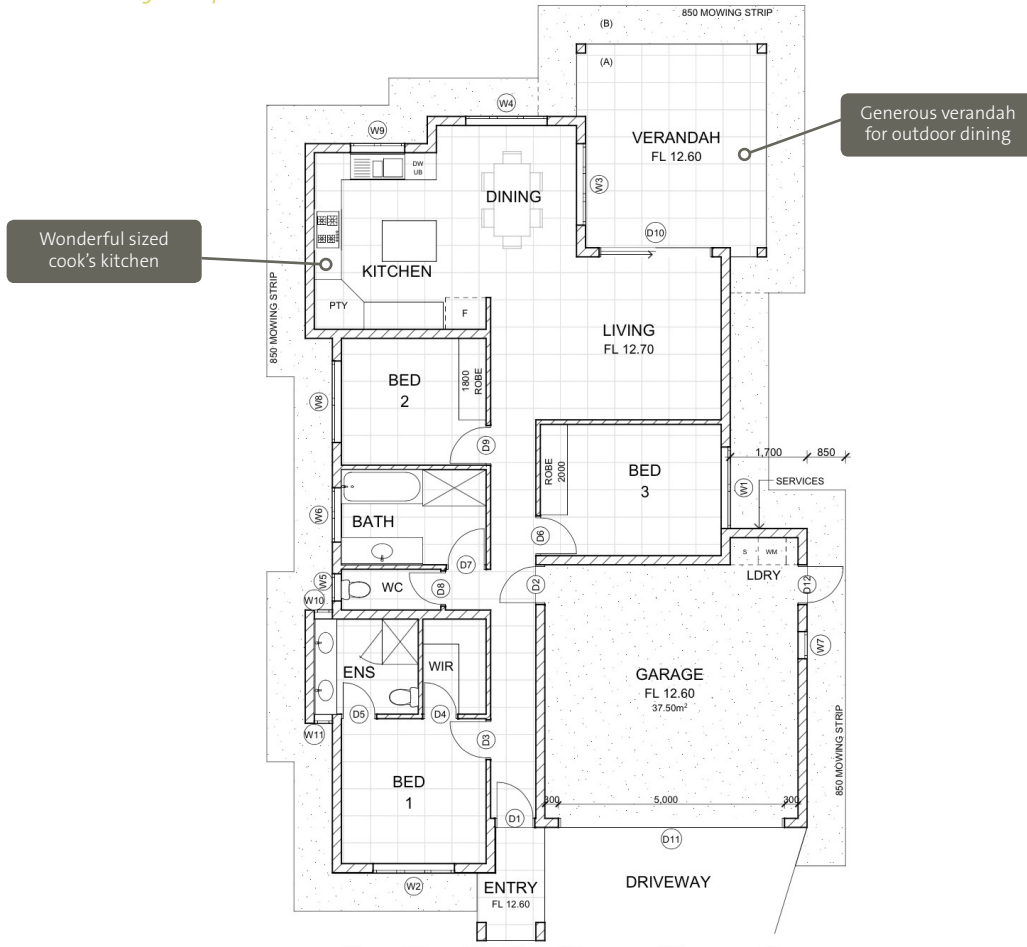

About Killarney Homes

At Killarney Homes, we're all about building your future with the best in beautiful, energy efficient homes for the tropics.

Our success as one of the Territory's highest-profile and most-respected building companies lies in our clear communication, efficient processes, and high quality, energy efficient housing that meets and exceeds the needs of our customers. Recently, this success culminated in us winning the 2014 Telstra Business Awards in the

Northern Territory Medium Business category. We're also proud to be on the board of the Northern Territory Master Builders Association and have won 80+ awards, including numerous HIA and GreenSmart accolades, cementing our reputation as the leader in sustainable Top End construction.

If you're ready to build your future with a beautiful, energy efficient home designed especially for the tropics, you're in the right place.

Contact us today



sales@killarneyhomes.com.au
PO Box 39947
Winnellie NT 0821

killarneyhomes.com.au (08) 8931 2122

